

RK-2106 HIGH GRADE MASSAGE CHAIR

Thank you for buying RK-2106 high grade massage chair, for better understanding on the operational method of the product, please read this operational manual before using, meanwhile, please keep this manual in good condition for reference, and pay more attention to attention for safety paragraph. Note: We reserve the right of design modification and explanation to our products; it is subject to change without notice, products color is subject to actual products.

Content

Function introduction	1
Attention for safety	1
Installation illustration	5
Name of external structure	7
Name of internal structure	7
Control usage	8
VFD screen illustration	10
Operational method and function illustration	11
FAQ and troubleshooting	13
Technical parameter	13
Schematics of mechanical parts	14
Mechanical parts list	15

Please keep the manual in a good place for future reference after reading.





Function introduction

1. RK-2106 is high-grade newly developed massage chair with engine shape and full function.
2. S-shaped back rail meets human body's curve, four-roller massage mechanism gives you a comfortable feeling.
3. Rolling, kneading, pressing, tapping and massaging on head, neck, back, wrist and hips can eliminate whole body's fatigue.
4. 6 air bags on two sides of seat, pressing massage mode for you to choose to easily remove fatigue.
5. 24 air bags and two vibration motors in legrest and footrest gives shanks and feet pulse pressing and high frequency vibration, which can promote circulation of blood capillary.
6. Upper cover of the armrest can be freely open/closed, a group of air bags on each of the two armrests, when the cover is open, it can massage arms and when closed, it will be naturally connected to the armrest.
7. Control with wide angle VFD display, active flip cover, intelligent sound/light navigation system. Open the cover to choose your favorite massage programs.
8. Adjust backrest and legrest with electric actuator, angle of backrest and legrest can be freely adjusted, which is more humanized.
9. Footrest can be flexibly stretched out or retracted within 13.50cm, specially designed for people of different body height.
10. Mechanical drive and mule design bring you silence and gentle feeling.

Attention for safety



- Please read the manual carefully before use in order to install and operate the massager in correct way.
- Attention for safety is made into two terms of warning and caution.

Please make sure the power switch is at "OFF" position before inserting the plug into the socket.

	Warning	This sign indicates "warning of causing possible death, hurt to body".
	Caution	This sign indicates "caution of causing possible hurt, damage to things".
	This sign indicates "forbidden behavior".	This sign indicates "self disassembly is forbidden".
	This sign indicates "must follow instruction to operate".	This sign indicates "correct operation way for wire".



Attention for safety

Warning



	<ul style="list-style-type: none"> ● For the following users, please consult the doctor before using: Cancer patient Osteoporosis patient Malignant tumor patient People with heart problems Pregnant and menstrual women People with severe wounds People with acute disease People with acute problems People who have consciousness problems Diabetics Patient with abnormal spine Patient with high fever due to disease People who are embedded gasometer inside the body People who need still care or feel uncomfortable People who have thrombus, severe aneurysm, acute venous aneurysm, blood circulation obstacles, skin diseases, skin infection and those that the doctors don't suggest to massage.
	<ul style="list-style-type: none"> ● During operation, if you feel abnormal or abnormal phenomenon occurs, please consult doctor to avoid any accident or bad effects to your body. ● Make sure there is nobody or something around (under, behind or in front of) the chair when using backrest, legrest up/down or legrest extension function. ● Please don't do too much massage on head. ● Before use, please check carefully if there is any defective cloth, for any minor broken cloth, please unplug the power and have it replaced instead of continuous use. ● Children are not allowed to use the massager nor play on it, standing or sitting on back or armrest is also not allowed. ● Those who can't express himself or can't operate it by himself are not allowed to use it in case of any accident or hurt. ● Power cord, plug, socket can't be used in broken or loose contact condition. ● Don't use other power except rated voltage in case of fire, electric shock or any breakdown.
	

Attention for safety

Warning



	<ul style="list-style-type: none"> Any broken, re-procesed, knotted, twisted and pressed power cord under heavy cargo is not allowed to use, especially under this massage chair, massage pad and other parts are forbidden to be stored in folding status otherwise it may cause short circuit, fire or electric shock.
	<ul style="list-style-type: none"> For any troubles in the massage, make sure to have it repaired by professional repairman, self-modification, disassembly or maintenance is forbidden. If power cord is damaged, please don't replace it by yourself, please contact us or appointed dealer for replacement.

Caution

	<ul style="list-style-type: none"> Please operate the chair in a flat or even place to avoid falling down. Please check if the massage heads are in correct position before you sit on the chair to avoid any possible accident or hurt. It is suggested that every operation time is 20mins and max. Every massage for one same position, and please begin with slight-slow massage, long time continuous massage on same position may cause uncomfortable feeling. Please turn off the switch behind the massage after use to prevent children from playing on it. For sake of safety, please insert the plug into the socket with earth wire; the plug of earth wire can't be bended or removed in case of electric leakage or shock.
	<ul style="list-style-type: none"> Don't press with hands or step on the massage heads with feet. Don't put hands between the working massage heads. Don't put hands or feet between mechanical parts. Don't stand or sit nor put something on the backrest, armrest or legrest. Don't move the chair during it is working. Don't put your hands or head between legrest or place under it. Don't massage when you have hard hairpin on. No hard things inside the pocket when massaging hip or thighs. Don't pull out the plug or turn off the power during operation.

Attention for safety

Caution

	<ul style="list-style-type: none"> Please don't sleep during operating the chair. For drunk people or those who feel uncomfortable, please don't use the chair. No water, dust or other waste things is available on the power plug; otherwise it may cause fire, electric shock or short circuit. Operating the massage chair on heating items like electric heat blanket is strictly forbidden otherwise it may cause fire. Be careful not to drop or embed anything into the slot of massage chair in case of any damage to it. Don't put the chair in direct sunlight, or close to stove, heating machine system; otherwise it may fade leather surface.
	<ul style="list-style-type: none"> Please don't use or store it in the wet place like swimming pool, bathroom, etc. Keep dry on the control and chair itself, please don't operate the chair when you are in wet in case of electric leakage or shock.
	<ul style="list-style-type: none"> Please unplug the power when repairing or clearing the chair, don't touch plug with wet hands in case of electric shock or hurt. Please turn off the switch immediately when electricity is off in case of any possible accident or hurt when the electricity comes on again. Please be sure to take PLUG out of the socket instead of holding power cord to unplug it otherwise the plug may drop or cause electric shock troubles.



Cleaning

- For normal use, clean it with dry cloth, chemical detergent is not allowed to use.
- For dirt or dust, please clean it with soft cloth with warm water or with neutral detergent, then re-clean it with twisted dry cloth, let it dry naturally, don't clean it with diluent or alcohol or gasoline.



Earth wire is not allowed here

Gas pipe, probably cause explosion or fire.
Phone wire and lightning rod, probably cause electric shock and fire when thundering.
Water pipe, earth wire is useless where there are glasses.

Installation illustration

There are two packing ways for this chair: one is backrest folding packing, the other is backrest flat packing, for backrest folding packing, the two armrests are attached as parts of the chair; for backrest flat packing, the two armrests have already been installed onto the chair.

Step 1
Take the chair, left and right armrest out of packing carton by two or more people. No attached armrests if the chair has already been installed armrests.



Step 2
Raise the backrest backward until about 110°, the backrest is fixed in a correct position with a crash sound.

Step 3
Connect the air pipe on the armrest body to the pipe mouth on armrest cover, assembly the armrest onto the blowing parts of the armrest body, be sure to fully reset the air pipe into the square hole of blowing parts. In case the air pipe is broken, push it forward and screw it on. (same installation method for left and right armrest.)

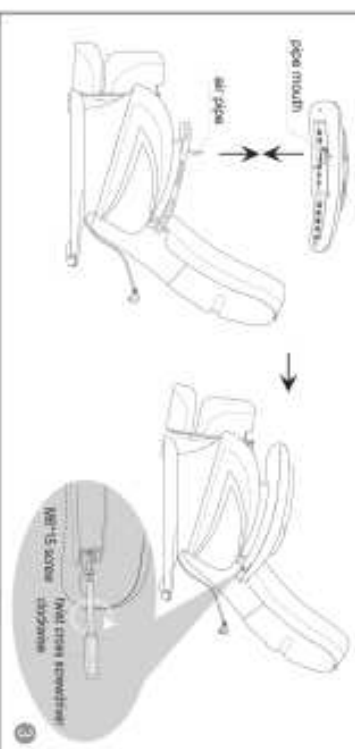

5

Installation illustration

Step 4
Connect the back pad, head pad with the chair back.



Step 5
Install the control bracket to the right armrest with three screws, put the control into the control holder.

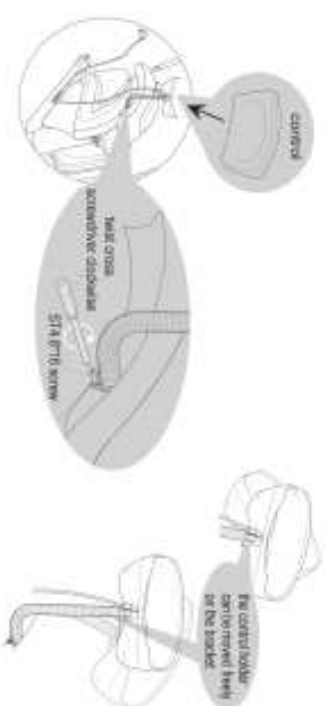

Step 6
After completing installation, turn on the power, open switch on the out side of right armrest, choose your favorite function to enjoy gentle and comfortable massage.



6

Name of external structure

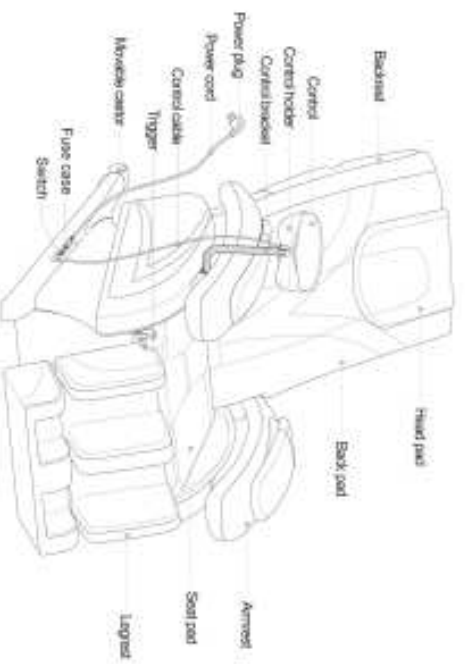

Name of internal structure

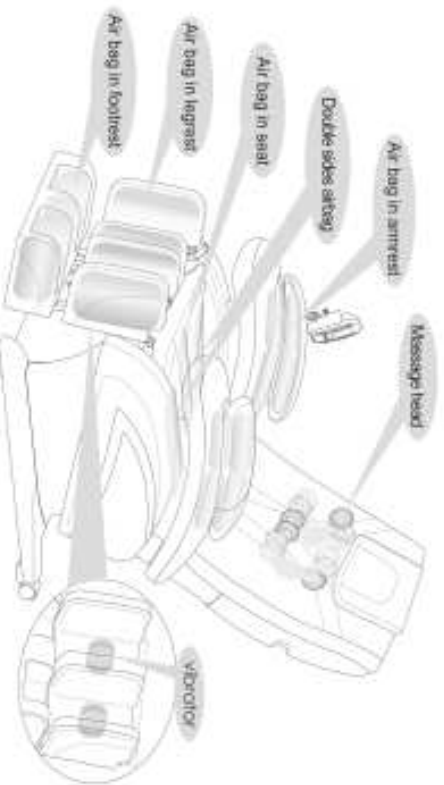

Control usage

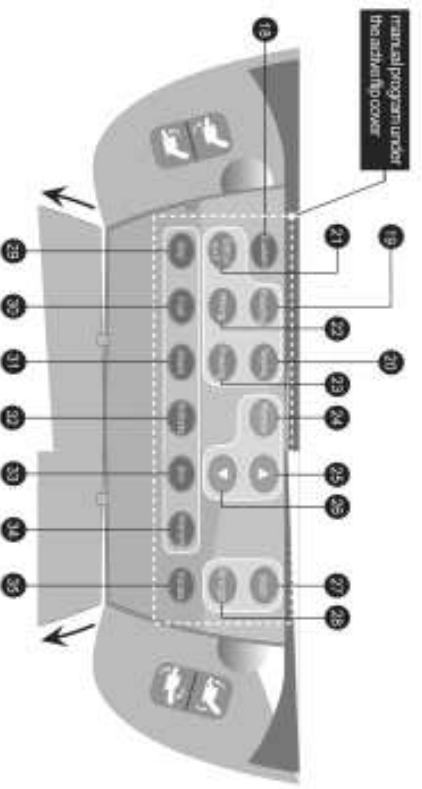
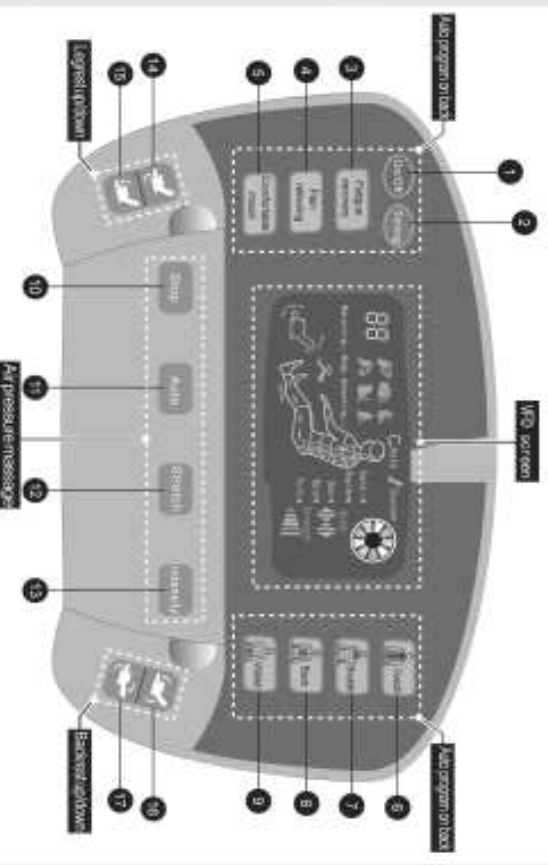

Control usage

1. Turn on/off the massage machine, when power is on, default working time displayed on VFD is 20min, full course, "shoulder", "back", "waist" indicators will flash, you may choose auto message program, i.e. press any one of the "full course", "shoulder", "back" and "waist" keys, then indicators of "tissue recovery", "pain relieving" and "comfortable mood" will flash, you may choose any one of them, the massage machine will automatically work as per your choice; open the cover below the screen and press "custom" key to choose your favorite message function manually. Turn off the power, the massage machine will be stored automatically.
2. During working mode, press this key to set three shifts working time: 10mins, 20mins and 30mins.
3. During working mode, press this key to choose "Fatigue recovery" function.
4. In auto mode, press this key to choose "Pain relieving" function.
5. In auto mode, press this key to choose "Comfortable mood" function.
6. In "ON" status, press this key to choose automatically upper body full course massage.
7. In "ON" status, press this key to choose automatically shoulder massage.
8. In "ON" status, press this key to choose automatically back massage.
9. In "ON" status, press this key to choose automatically waist massage.
10. In "ON" status, press this key to stop air pressure massage on legs, legs, feet and arms.
11. In "ON" status, press this key to choose automatic air pressure massage. VFD will display "AU".
12. In automatic air pressure working mode, press this key to open/close legrest stretching function.
13. In air pressure working mode, press this key to choose intensity of air pressure massage.
14. Press this key, the legrest will go up, release it, the legrest will stop going up.
15. Press this key, the legrest will go down, release it, the legrest will stop going down.
16. Press this key, the backrest will go up, legrest will go down, release it, the backrest and legrest will stop going up/down.
17. Press this key, the backrest will go down, legrest will go up, release it, the backrest and legrest will stop going up/down.
18. In "ON" mode, press this key to choose your favorite massage function manually.
19. In "CUSTOM" mode, press the key to start kneading massage.
20. In "CUSTOM" mode, press the key to start tapping massage.
21. In "CUSTOM" mode, press the key to start "kneading and tapping" massage.
22. In "CUSTOM" mode, press the key to start hitting massage.
23. In "CUSTOM" mode, press the key to start pressure massage.

Control usage

24. In "CUSTOM" mode, press this key to choose massage position such as full course, shoulder, back, waist and fixed position.
25. In "CUSTOM" mode, when you choose "fixed massage position", press "▲" to slightly adjust massage position upward.
26. In "CUSTOM" mode, when you choose "fixed massage position", press "▼" to slightly adjust massage position downward.
27. In "CUSTOM" mode, when you choose "tapping, pressing, hitting function", press this key to adjust width between two sets of rollers.
28. In "CUSTOM" mode, when you choose "tapping, kneading/tapping, hitting function", press this key to adjust massage strength.
29. Press this key to stop air pressure massage on feet, shanks, hips and arms.
30. In "ON" mode, press this key to open/close air pressure massage on feet.
31. In "ON" mode, press this key to open/close air pressure massage in shanks.
32. In "ON" mode, press this key to open/close air pressure massage in hips.
33. In "ON" mode, press this key to open/close air pressure massage in arms.
34. When air pressure is in "ON" mode, press this key to choose air pressure intensity on feet, shanks, hips and arms.
35. In "ON" mode, press this key to open/close vibration massage on shanks.

VFD screen illustration

88 Digital display: Standby is in "—" status showing balance working time, when the air pressure is in "ON" mode, press air pressure's "auto" key, it shows "AU", press "intensity" key, it shows "E1", "E2", "E3", "E4" as different intensity level, if the machine is in abnormal status, it shows "E".

Sweating Tapping Shuttle Pressing Hitting	Automatic / Custom Air pressure Vibration Intensity	orange - fatigue recovery green - pain relieving blue - comfortable mood up/down
---	--	---

Leg stretch
 air pressure posture
 massage roller posture
 extension posture in legrest

Overtake ▲
 Shoulder ▲
 Back ▲
 Waist ▲
 Print ▲

Operational method and function illustration

● Operational procedure

Step 1. Turn on power

- Put the plug into socket
Open power switch on the bottom of the outside right of the armrest, the machine is on standby status.

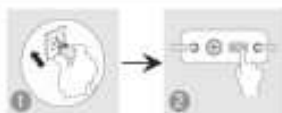

Step 2. Massage

Choose massage function as per control operation instruction.

Step 3. Turn off the power

- Press on/off key on the control to turn off the massage machine
- Turn off power switch on the bottom of the outside right of the armrest after the rollers stay at storage position.
- Unplug the power from the socket



● Backrest up/down

▶ Backrest down

Press i° j^{\pm} key on the control, the backrest will go down and legrest will go up simultaneously. Release this key; the backrest and legrest will be fixed at locked angle.



◀ Backrest up

Press i° j^{\pm} key on the control, the backrest will go up and legrest will go down simultaneously. Release this key; the backrest and legrest will be fixed at locked angle.

Operational method and function illustration

● Legrest up/down

▶ Legrest down

Press legrest i° j^{\pm} key on the control, the legrest will go down slowly. Release this key, the legrest will be fixed at locked angle.



◀ Legrest up

Press legrest i° j^{\pm} key on the control, the legrest will go up slowly. Release this key, the legrest will be fixed at locked angle.

● Legrest stretched out/retracted

▶ Legrest stretched out

Pull the trigger on the right of legrest backward till ideal angle while the feet stretch forward, the legrest will be fixed at this position, stretching range is within 13.50cm.

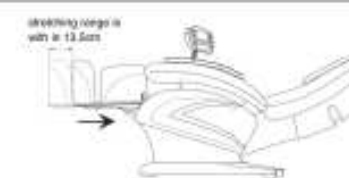
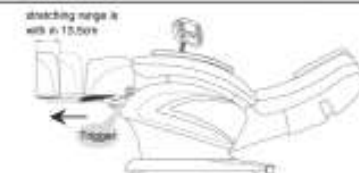

◀ Legrest retracted

Pull the trigger on the right of the legrest backward till ideal angle while the feet retract, the legrest will be fixed at this position, retracting range is within 13.50cm.



Please make sure there is nobody, no pet or nothing within permitted range for backrest and legrest to avoid any unexpected hurt or property loss. When you adjust the backrest, be careful with the gap between the backrest and armrest.

Operational method and function illustration

● Arm massage

Open upper cover of the armrest, put arms on the armrest, press "auto" key on the control or "arm" key under the active flip cover to enjoy air pressure massage.

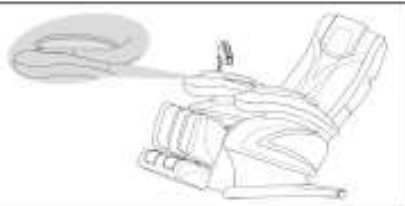

● Moving

Turn off the power and unplug it (it is better to make the chair in storage status to avoid any damage to the backrest when moving it), press down the backrest as showed in the picture, push the chair forward with the castors and put it down slightly.



⚠ Note

Power cord should be wrapped on the chair seat in case of damage to it during moving. Please put down the chair slightly otherwise some parts may be damaged due to rough handling.
Don't use castor on uneven ground.
Please don't push the chair on wood floor as the castor may scratch the floor, if needed, please raise the chair by two or more people working together.

● Kind suggestion

Due to the chair itself weight, long time pressure on the floor may leave scratches on it, it is suggested that you put a piece of carpet or something soft for floor protection.



FAQ and troubleshooting data

Trouble	Possible reason	Troubleshooting
The massage chair can't work after power is on	Check if the switch is on or not. Not choose massage function. Check if the plug and socket is loosely contact or not	Open control switch; Choose massage function; Check plug and socket
There is beep sound inside the massager while working	It is sound of air pump, motor and mechanical parts	normal, Normal sound, no need to pay attention to it.
Sound suddenly becomes much louder while working	Check if it is due to long time working	Turn off the power to have the massager rest for over half an hour before next turn working
Massage function suddenly stops while working	Setting time is up	Turn off the power to have the massager rest for over half an hour before next turn working
Neither the backrest nor the legrest can be laid down	Check if there are any obstacles; the chair overloads; for the sake of safety, sometimes the massage machine may automatically stop working	Remove the obstacles; turn off the power to have the massager rest for over half an hour before next turn working.
The chair can't return to its original position	Excessive operation; setting time is up	Turn off the power to have the massager rest for over half an hour before next turn working
Power indicator doesn't come on even if turning on the power switch on the outside of the right armrest	Check if the plug and socket are loose contact or not. Check if the fuse is blown out or not	Make plug and socket is in good contact; Change fuse of same specification

Note: If above-mentioned reasons are not included, please turn off the power switch on the outside of the right armrest, unplug the power and contact your dealer or our company for repair or maintenance.

Technical parameter

Name	RK-2106 high grade massage chair	Power	220W
Type	RK-2106	NW/GW	80/94 KGS
Input voltage	<input type="checkbox"/> AC110V <input type="checkbox"/> AC220V-240V 50/60Hz	Packing size (mm)	<input type="checkbox"/> 1170X840X860
Working voltage	DC 110V	Safety design	Class I

Schematics of mechanical parts

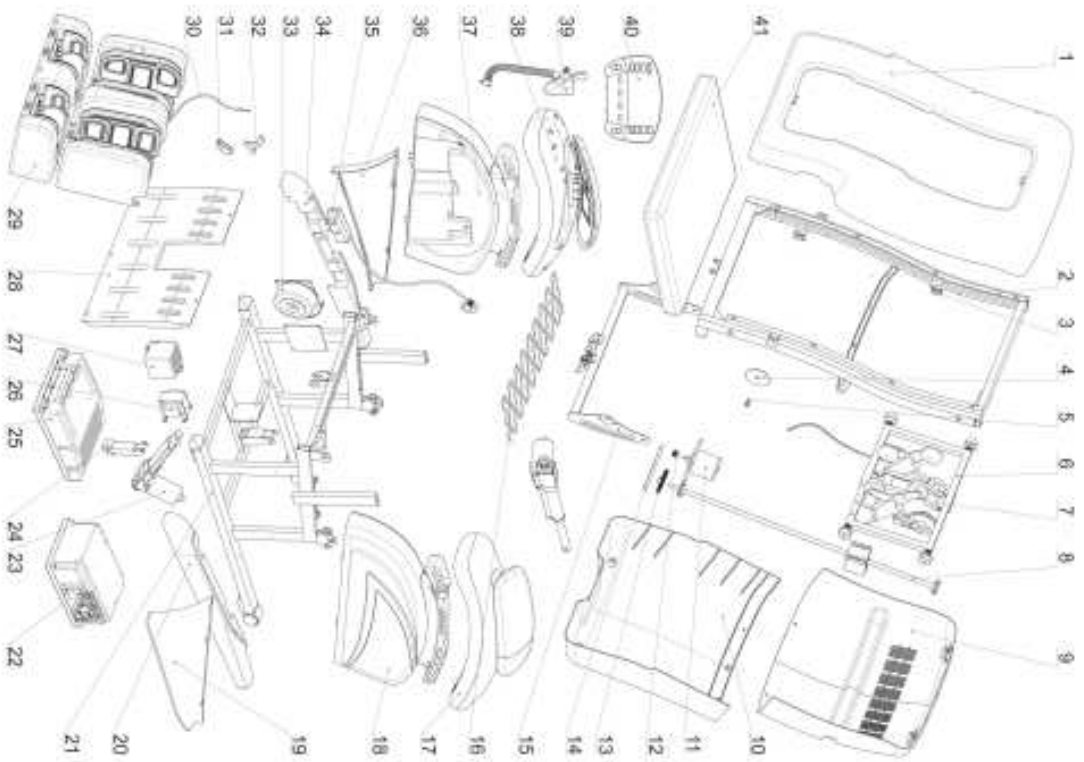

Mechanical parts list

No.	Name	Qty (pcs)	No.	Name	Qty (pcs)
1	Backrest frame	1	2	Backrest welding assy	1
3	Stroke switch	2	4	Anti-abrasion piece	2
5	Strip screw	2	6	Back massage assy	1
7	Internal machine assy	1	8	Guide screw assy	1
9	Upper back cover	1	10	Lower back cover	1
11	Guide screw motor	1	12	Small belt wheel	1
13	Big belt wheel	2	14	Belt	1
15	Rotation frame	1	16	Seat spring	1
17	Left armrest	1	18	Left armrest assy	1
19	Fender of left armrest	1	20	Left armrest bottom part	1
21	Seat frame welding parts	1	22	Gas case	1
23	Electric cylinder	2	24	Legrest lever hook	1
25	Power case	1	26	E-shape transformer	1
27	Transformer cover	1	28	Front fender	1
29	Legrest assy	1	30	Cable	1
31	Cable holder	2	32	Cable trigger	2
33	Circular transformer	2	34	Right armrest bottom parts	1
35	Switch case assy	1	36	Fender of right armrest	1
37	Right armrest assy	1	38	Right armrest	1
39	Control holder	1	40	Control	1
41	Seat cover	1			

Please read the "Attention points for safety"
carefully before using Operational manual!

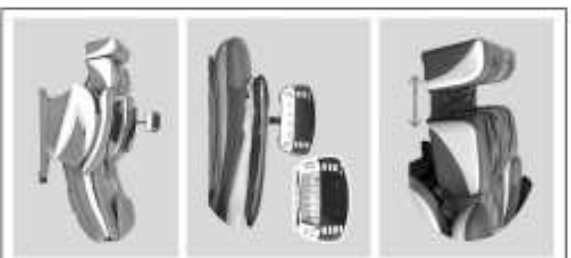

RK - 2106

HIGH GRADE MASSAGE CHAIR

Operational manual

