

*Make your life healthy  
and beautiful every day!*

# Massage Chair

## **RK1901**

### User ' s Manual



Please read SAFETY INSTRUCTIONS carefully before using the chair.

# Massage Chair RK1901 Function Introduction

1. With intelligent soft 3D massage machine in back , it can provide you a very comfortable massage on neck and back by doing the different techniques like kneading , tapping , pressing, knocking and shiatsu. Let you enjoy the massage feeling like a real professional massagist.
2. With acupuncture point tracking detecting function . It can supply exact massage according to different people with different body height and shape.
3. Combined with human body engineering research and development of super long L-shape curve guide , make you fully enjoy intimate massage from head to leg , achieve the result of rapidly a alleviate the pressure of the spine.
4. One-button press to perform zero gravity lie down function . It can effectively alleviate the pressure on spine and joints, allowing you to experience the real zero gravity.
5. The forward sliding function of 0cm from the wall. The backrest and seat frame move together , that can take full advantage of space , the design is full of humanization and will give you perfect feeling .
6. The foot parts with full scrapping function, with rollers in feet , combination with gentle air bag force to stimulate the soles .
7. Leg parts equipped with multiple airbags,to perform pulse air pressure massage on legs , to promote blood circulation and restore the vitality .
8. Air pressure squeezing massage on your arms, which can promote blood circulation of blood capillary.
9. The legrest and foot parts can be adjusted to any angle that you need. It can extended and retracted within the range of 23cm , suitable for different people to use .
10. High resolution colorful LCD controller, which can show the massage parts , methods and status all the same time.

- ✦ 1.Thank you for choosing this RK1901 Massage Chair.
- ✦ 2.Please read this manual carefully before using the massage chair.
- ✦ 3.Please keep this manual in a safe place for further reference.
- ✦ 4.Please pay attention to SAFETY INSTRUCTIONS.

✦ Note: We reserve the right for design modification. It is subject to change without notice. The pictures in this manual are only for reference. Please refer to the actual product.

## Content

<b>Preparation</b>	Safety instructions -----	1
	External structure parts -----	5
	Internal structure parts -----	6
	Mechanical components diagram -----	7
	Mechanical components list -----	8
<b>Installation</b>	Installation -----	9
<b>Massage Operation</b>	The adjustment before massage -----	13
	Manual control -----	15
	Operation instruction &function illustration -----	21
	After massage -----	24
<b>Maintenance</b>	Clean and maintenance -----	25
<b>Others</b>	Malfunction guide -----	26
	Technical data -----	27

Please keep this manual in a safe place for future reference.

**Caution**

	<ul style="list-style-type: none"> <li>Please operate the chair in a flat or level place</li> </ul>	To avoid sudden falling.
	<ul style="list-style-type: none"> <li>The maximum suggested operating time is 20mins. 5mins for each position beginning with the slight- step massage. Along continuous massage in the same position may cause uncomfortable feeling.</li> </ul>	Too long time massage is bad for your body.
	<ul style="list-style-type: none"> <li>Before sitting on the chair to avoid injury please inspect everything to confirm that the massage heads are in the correct position.</li> </ul>	To avoid accidental injury.
	<ul style="list-style-type: none"> <li>Remote control should be put in the pocket or on the bracket. Do not put the remote control anywhere casually in case of remote control damage.</li> </ul>	
	<ul style="list-style-type: none"> <li>Please make sure that the power switch is at the "OFF" position before inserting the plug into the socket.</li> </ul>	To avoid the accident when turn on the power.
	<ul style="list-style-type: none"> <li>Turn off all controls before removing plug from outlet.</li> </ul>	To reduce short circuits and any fire hazard.
	<ul style="list-style-type: none"> <li>Make sure the plug completely insert into the socket.</li> </ul>	To avoid electric shock in any leakage or breakdown.
<ul style="list-style-type: none"> <li>Checking whether any damage on wire, make sure no water or rubbish on wire.</li> <li>Installing earth wire in correct way. The plug must be inserted into socket with earth connect, the earth connect couldn't be bend or cut off. </li> </ul>		
	<ul style="list-style-type: none"> <li>Don't press with hands or step on the massage heads with feet.</li> <li>Don't put hands between the working massage heads.</li> <li>Don't put hands or feet in the gap of mechanical parts.</li> <li>Don't drop or embed anything into the slot of massage chair.</li> <li>Don't stand or sit or put anything on the backrest, armrest or leg-rest.</li> <li>Don't stand on the chair during operation.</li> <li>Don't move the chair during operation.</li> <li>Don't pull out the plug or turn off the power during operation.</li> <li>Don't put your hands or head between leg-rest or beneath.</li> <li>Don't use the massage chair while wearing hair ornaments.</li> <li>Don't put hard things in pocket when take buttocks and huckle massage.</li> <li>Don't sit or press on the backrest when the chair is in reclining position.</li> <li>Don't use at bare skin or were thin clothes, thin clothes may can achieve better massage effect, But it also may cause irritation to the skin or cryogenic burns.</li> </ul>	To avoid accidents or injury
	<ul style="list-style-type: none"> <li>Keep the chair away from heat, wet, sharp things and corrosive, inflammable, explosive environment.</li> <li>To use electric blanket or other heating products on the chair is forbidden.</li> <li>Don't put in the space of dust serious or corrosive gas environment,</li> <li>Don't put the chair in a small space places or use in the bad air circulation places.</li> <li>Keep the chair away from stove or other heating products.</li> <li>Don't put the chair directly under the sun or other high temperature places.</li> </ul>	To avoid fade, discolor on upholstery or hardened, deteriorated on PU.
	<ul style="list-style-type: none"> <li>Don't use the chair outdoor.</li> </ul>	

**Caution**

	<ul style="list-style-type: none"> <li>Don't use or store the chair in the wet environment like nearing the swimming pool, or bathroom.</li> <li>Keep the chair and remote control dry all the time.</li> </ul>	To avoid leakage or electric shock.
	<ul style="list-style-type: none"> <li>Make sure to install the earth wire in correct way (Incorrect install way may cause electric shock. If you don't know how to install, please find a professional electrician)</li> <li>Don't use plug adapter (If the enclosed plug doesn't match with socket, please don't change the plug by yourself and find a professional electrician to install a matched socket. )</li> </ul>	To avoid electric shock.
	<ul style="list-style-type: none"> <li>Unplug the power before cleaning the chair.</li> <li>Unplug the power after using the chair.</li> </ul>	To avoid electric shock or fire hazard.
	<ul style="list-style-type: none"> <li>Unplug the power when any damage on the power.</li> <li>Hold the plug to unplug the power but not try to pull the wire to unplug the power.</li> </ul>	
	<ul style="list-style-type: none"> <li>Please turn off the power switch and unplug the power after massage.</li> </ul>	To avoid accidents
	<ul style="list-style-type: none"> <li>Unplug the power immediately when electricity goes off.</li> </ul>	To avoid damage or accidents when power on again.

**Grounding instruction**

- ✧ ※The chair is equipped with a cord having an grounding conductor. The plug must be plugged into an appropriate socket that is properly installed and matched with the plug.

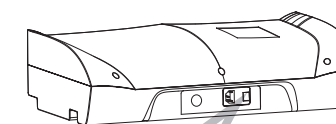
**Replace fuse**

- ✧ ※When the fuse is burned out, please turn off the switch and unplug the power. Opening the lid covered the fuse which is located in the switch box. Using a same size fuse to replace the old one, then cover the lid. Or you can find an electrician to replace the fuse.

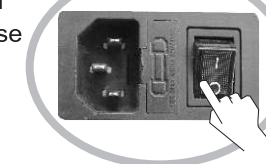

**Earth wire is not allowed to be in these places**

Gas pipe: probably cause explosion or fire.  
Phone wire and lightning rod: probably cause electric shock and fire when thundering.  
Water pipe: earth wire is useless where there are plastics

External structure



Preparation

Internal structure



Preparation

Explosion Diagram

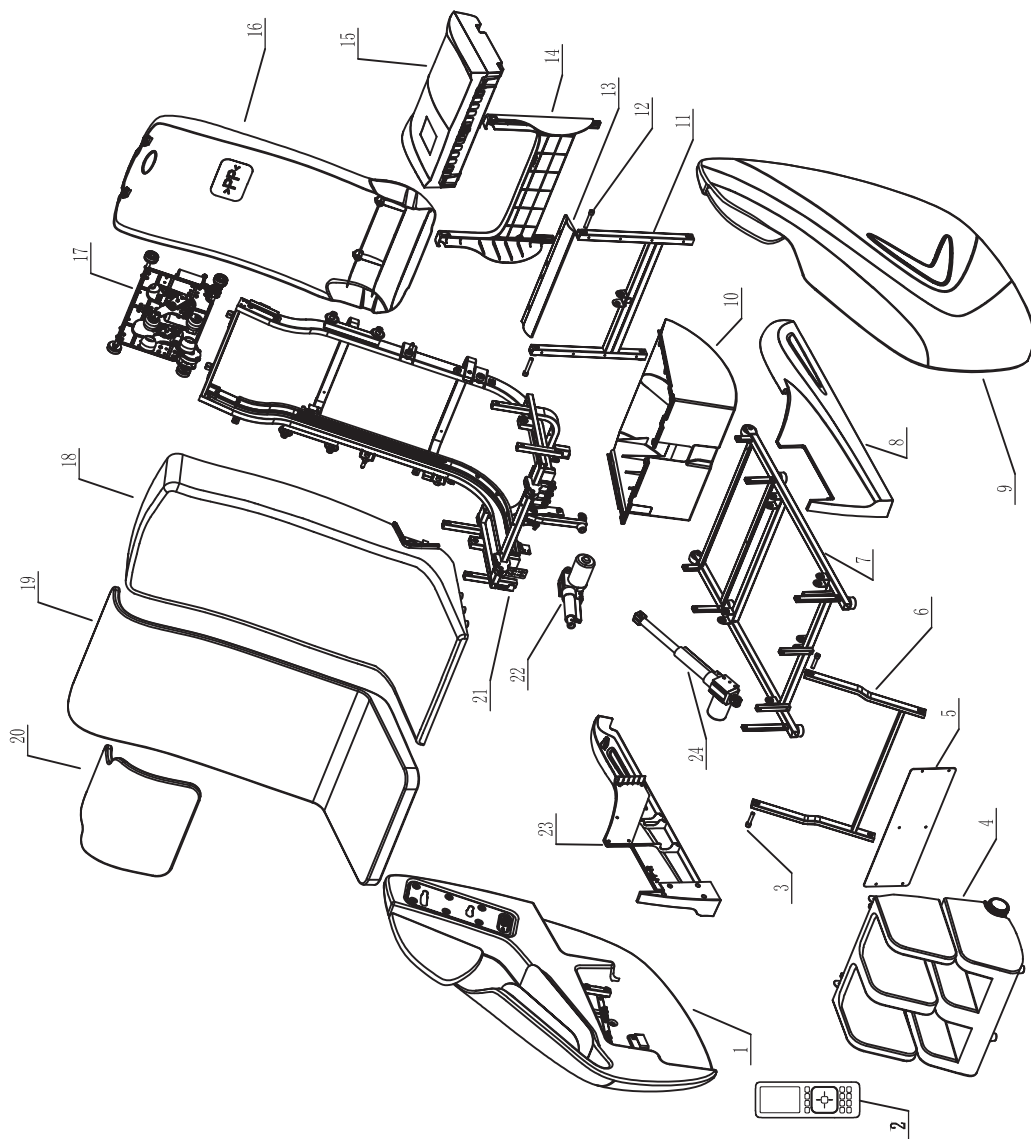

Preparation

Mechanical components list

NO.	Name	Q' ty	NO.	Name	Q' ty
1	Right armrest assembly	1	22	Seat electric actuator	1
2	Remote control	1	23	Right side fender	1
3	Back bolt 2	1	24	Footrest electric actuator	1
4	Legrest&Footrest	1			
5	Front fender	1			
6	Front swing assembly	1			
7	Bottom frame assembly	1			
8	Left side fender	1			
9	Left amrest assembly	1			
10	Front protective cover	1			
11	Back swing assembly	1			
12	Back bolt 1	1			
13	Back fender 2	1			
14	Back fender 1	1			
15	Power case assembly	1			
16	Back cover	1			
17	Rk11 massage machine	1			
18	Backrest	1			
19	Back cushion	1			
20	Pillow	1			
21	Back frame assembly	1			

Preparation

## Assembling 1

## Step 1. How to move the chair.

① Take out the manual and power cord box first, then the massage chair body from the box. It takes at least two people to lift the chair body. Hold the lower part of the armrest and carry out the chair slowly. (As the photo shows.)

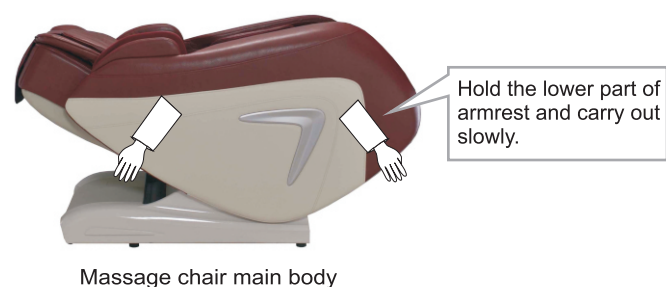

② Take out the leg-rest from its box by holding the two sides of leg-rest.



## Step 2. Let Massage Chair Return to Upright Position.

① Take out the power cord and plug one end into the hole on the power box under the chair's back-rest, plug the other end into the power outlet. ② Turn on the switch on the power box. The back-rest shall move up and seat shall get down accordingly. ③ After the chair returns to upright position, switch off and plug off by referring to Step 4.

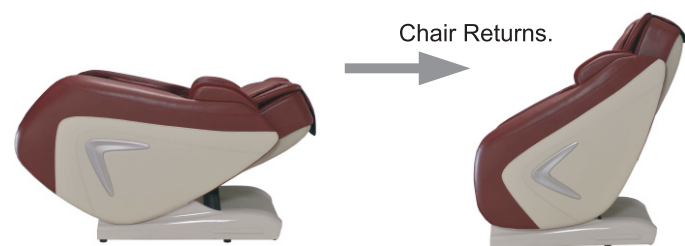

## Assembling 2

## Step 3 Fix the Leg-rest

Fix the leg-rest on the main body. ① Put the rear of leg-rest near the seat front part. ② Plug off the pine leaf pin on the leg-rest rear connecting rod and pull the shaft and two shaft sleeves out from the connecting rod hole. ③ Raise the seat front connecting rod and insert those two shaft sleeves from the two sides of connecting rod hanger into the holes. ④ At the same time, lift the rear leg-rest connecting rod, align it with the hanger hole, insert the shaft into the hole and lift the other connecting rod and insert the shaft into the hole. ⑤ Plug the pine leaf pin in the small hole of shaft correctly. ⑥ Connect the air tubes of leg-rest with those of the chair body according to the same color in the right way tightly. From the left to the right, it's gray then dark brown. Under gray, it's the black one. ⑦ Plug the power cord into the socket. ⑧ Remove the screw of the leg-rest hanger. ⑨ Lift up the hanger shaft pressing plate and raise the bottom of leg-rest higher as the photo shows and put the shaft into the chair body hanger, then lower down the shaft pressing plate. ⑩ Fix the screw tightly.

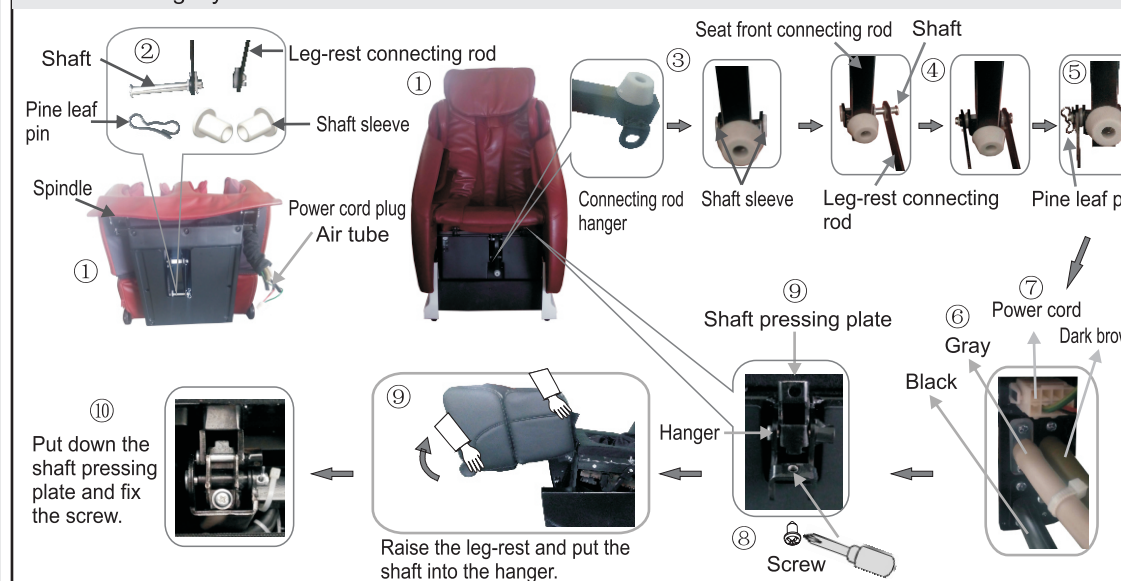

## Step 4. After Assembling.

After assembling, please follow the steps below.

- ① Insert the power cord into the socket on the power box under the back-rest (as photo shows).
  - Put one end of power plug into hole a.
  - Insert controller cable plug into Hole B, and fasten the cap.
- ② Put the other end of power plug into power socket.
- ③ Turn on the switch O/I. It means power on.
- ④ Select massage function by remote control and enjoy the comfortable massage.

⚠ Make sure the power switch is off before plugging into the power socket.

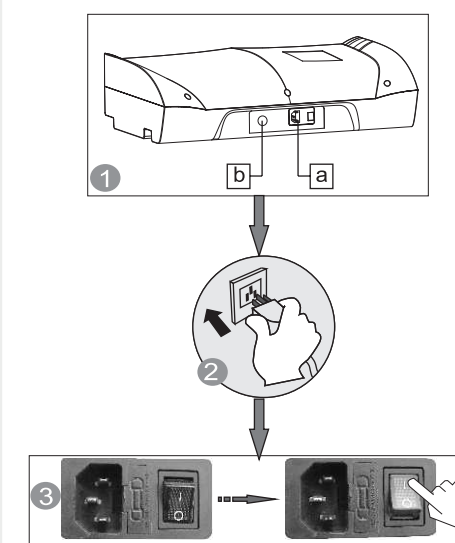

## Environment

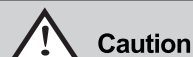

## Caution



Don't use the chair in wet places like near swimming pool, bath room to avoid leakage or electric shock.



Don't use under sunlight or near stove or other heating place to avoid upholstery deteriorated.



Please use chair in flat place to avoid chair falling or noise or other unexpected trouble.

## ● Check places in front

Check the areas when back and leg extending, make sure no people, pets or other things around.



## ● Check power cable, plug

- (1) Clean the dust on plug on time. (using dry cloth).
- (2) No damage, re-do, bend, stretch, tie or press with heavy thing (especially can't be pressed by the chair) on power cable.



## Check environment

## ● Space size for using the chair

- Micro space for the back-rest from the wall.



- At least 50cm ahead the chair.

## ● Check surroundings

When the backrest or legrest reclines or extends, please pay attention to:

- (1) Check any person or things in every direction.
- (2) Check the space size.



## How to move massage chair



## Caution

- ✦ Don't move chair when it's working in case of accidents or damage

## How to move

- ✦ Bind the cables and put them in the seat to avoid damage when moving.
- ✦ If you plump the chair, it may damage the inner parts of the chair.
- ✦ Don't use the castor if the floor is wooden or other easy damaged material. It will need 2 or more persons to lift the chair.
- ✦ Make sure the power is off and the plug doesn't touch the floor (It's better to let the chair in standing status to avoid the back crashing the floor)



## Normally

- 1 Lift up the legrest to make the gravity fall on the castor. Then push chair to destination and set it down.

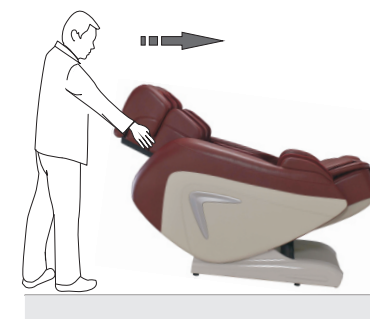

Please hold the footrest to move the chair as shown in the picture in case any scratches on the leatherette

## Adjustment before massage

## ● Before adjustment

- ✦ Please make sure the massage head in right position, then sit down (to avoid the massage roller hit your head)



## ✦ Acupuncture point tracking detecting

If massage head can't detect when acupuncture point position detecting, shoulder position was default to the highest position.

**Right position:** Your back cling to the chair back, the head clings to the pillow.



The remote control gives "beep" sound after acupuncture point tracking detecting finished, when micro-adjustment is needed, just press up/down key on the remote control.

- ✦ Avoid for the massage head detecting your acupuncture point position not right, otherwise you won't get good massage.

## ● Kind suggestion



- When you feel the intensity isn't strong enough, take off the pillow or cushion.

- Because the chair is heavy, it may ruin your floor in long time setting. Please put a blanket or other soft things to protect your floor.



## Manual control

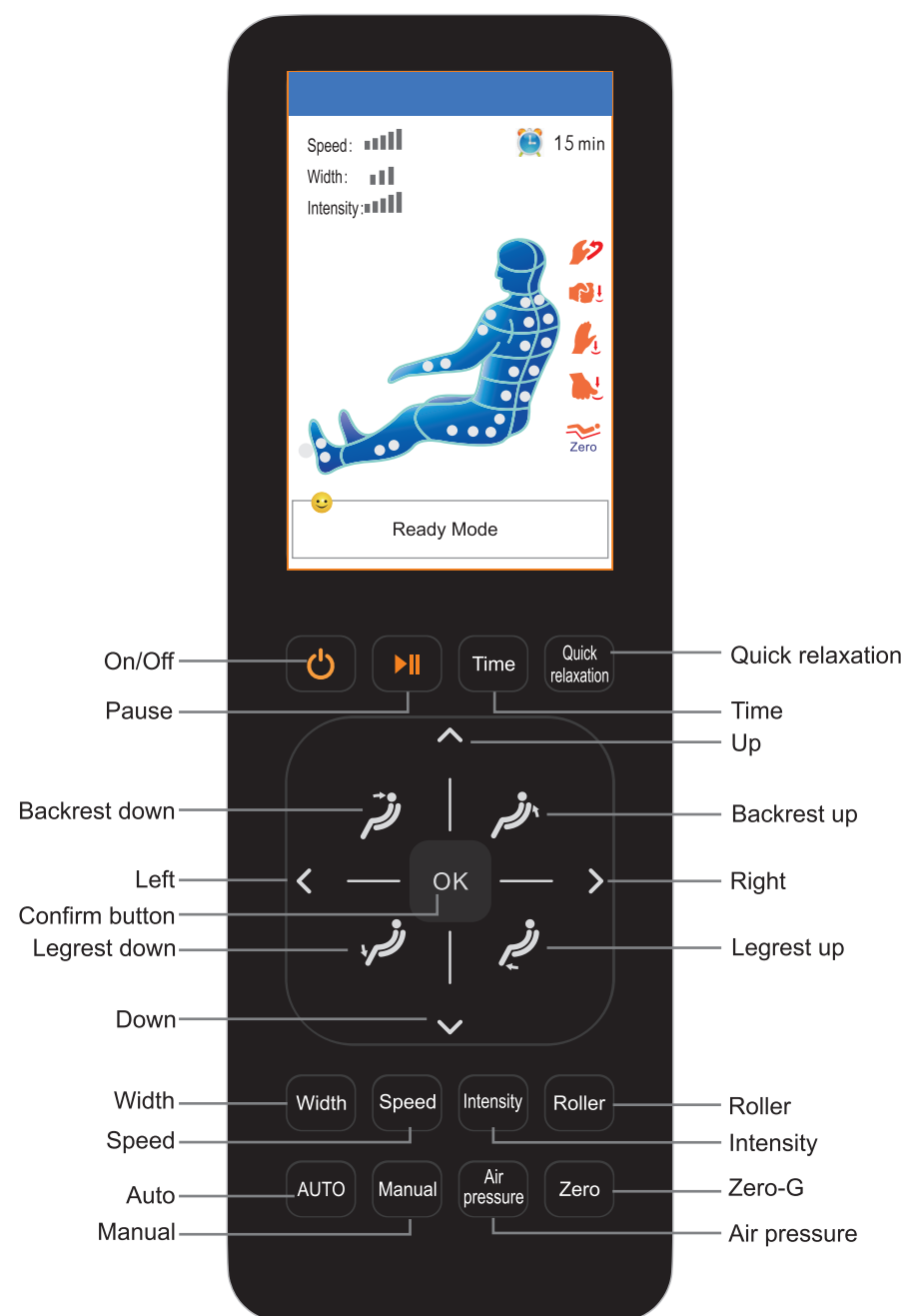

1. In standby mode, press the key to open the massage chair into the boot state. This time through the menu to select either automatic massage program, the massage chair begin to detect the shoulder height and begin to massage. In the boot state, click the key, the massage chair into shutdown reset process, the legs and the feet lower to the minimum, the back rise to the highest, the hand control will be off 6 to 10 seconds later after the massage chair completely reset.
2. In the boot state, press this button to immediately stop all massage functions, if you want to continue to massage, press this button again to resume.
3. In the boot state, press this button for adjusting the time, the order of 5 minutes, 10 minutes, 15 minutes, 20 minutes, 25 minutes, 30 minutes to cycle.
4. In the boot state, press this button to enter the "fast relaxation" automatic massage program. Default work time is 15 minutes.
5. Keep pressing this button, the backrest go down, release the button, the backrest stop moving.
6. Keep pressing this button, the backrest go up, release the button, the backrest stop moving.
7. Keep pressing this button, the legrest go down, release the button, the legrest stop moving.
8. Keep pressing this button, the legrest go up, release the button, the legrest stop moving.
9. In the menu mode: Press it to confirm menu choice and enter the next level of the menu.
10. The navigation keys have 4 buttons: up, down, left, and right, in the menu mode: use as menu navigation keys, press up or down button, can select the menu quickly, press left or right buttons, can quick access to the previous and next menu. In manual massage mode: Up and Down buttons can adjust the position of the massage machine when the programmes are under shoulder position detection function and fixed point adjustment function.
11. In the boot state, under knocking and tapping, press this key to adjust massage width, wide, medium and narrow.
12. In the boot state, and custom mode, press this key to adjust speed, 5 levels for choice.
13. In the boot state, press this key to adjust intensity, 5 levels for choice.
14. In the boot state, press this button to control the feet massage rollers.
15. In the boot state, press this button to enter the automatic massage modes, there are 9 automatic modes for selection.
16. In the boot state, press this button to enter the manual massage modes, there are 5 manual massage modes for selection.
17. In the boot state, press this button to enter the air massage modes, there are 3 air massage modes for selection.
18. In the boot state, press this button, the massage chair adjust into zero gravity status, press this button again, the massage chair reset into power-on status.



LCD display graphic description

Main Interface

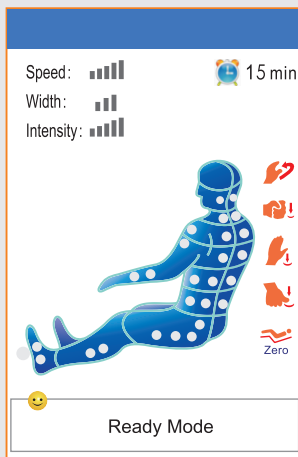

When the power is on, turn on the switch and there will be a loud and short sound from buzzer. The LCD displays the Main Interface and you will see the Ready Mode. The buttons are easy to operate; The LCD display normally after switch on; There is flash for abnormal occurrence. The Main Interface shows massage positions, methods, time, working status etc. All information will be updated timely when the chair starts working.

- Massage function
- Kneading
  - Tapping
  - Knocking
  - Pressing
  - Zero Gravity
  - Remaining time of massage.

Massage position

- Massage Speed (5 grades)
- Massage Width (narrow, middle, wide)
- Holographic massage Intensity (weak, middle, strong)

Massage operation

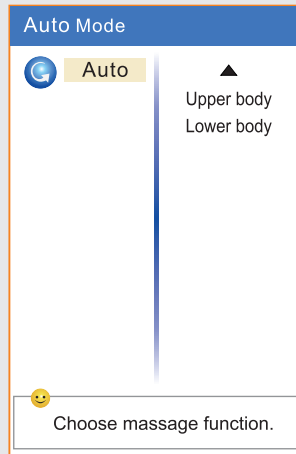
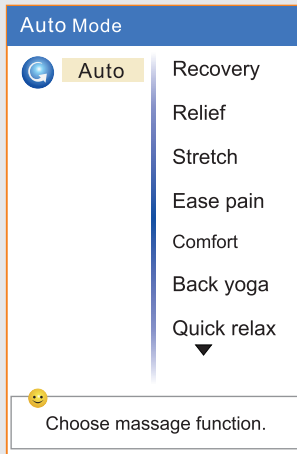

**Auto massage:** press Auto in main interface to enter auto massage, 9 programs for choice. recovery, relief, stretch, ease pain, comfort, back yoga, quick relax, upper body, lower body.

LCD display graphic description

On Main interface, press "Manual" to convert to Manual Interface. There are 3 manual massage programs for selection.

- 1.Mode: 5 massage methods including shiatsu, kneading, knocking, tapping, Kneading & knocking.
- 2.Massage position: neck, shoulders, back, waist & seat, overall.
- 3.Fixed point: On the Main Interface, use the up and down button to adjust massage position. When adjusting, the reminder bar will display the information "the massage position is adjusting."

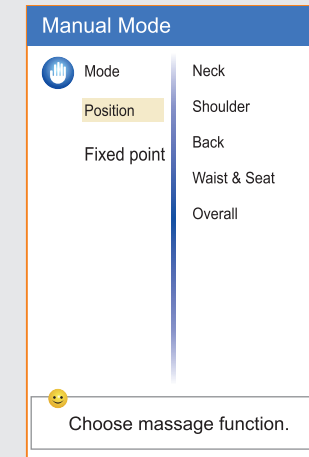
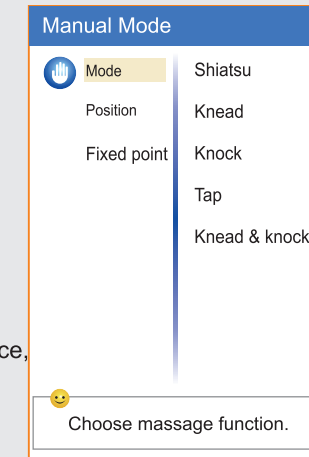

**Air massage mode:** 3 options: arm & shoulders, calf & foot, full body.

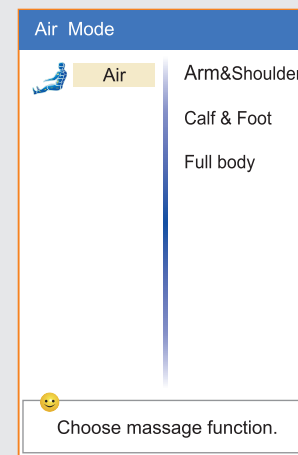

After switch on, the massage chair will start acupuncture point detecting for the first time. After detecting there will be a beep sound (every second) and the screen will display the message "please adjust your shoulder height directly". During this period, if you feel the height is not enough, you can use "up" or "down" button to adjust your shoulder position.



Massage operation

## ON/OFF

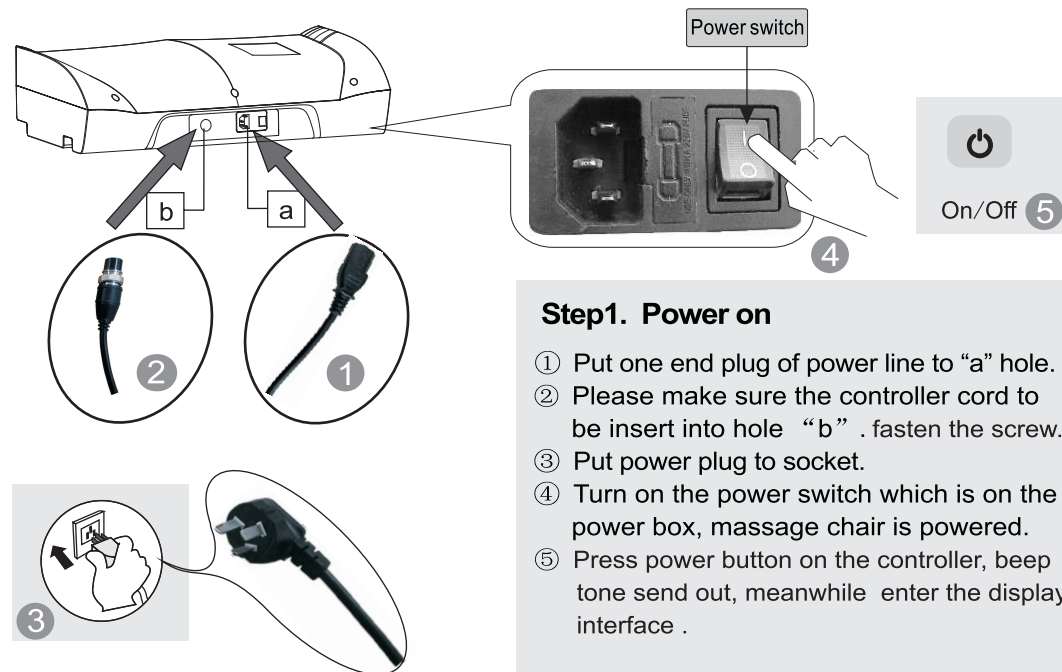

## Step1. Power on

- ① Put one end plug of power line to "a" hole.
- ② Please make sure the controller cord to be insert into hole "b" . fasten the screw.
- ③ Put power plug to socket.
- ④ Turn on the power switch which is on the power box, massage chair is powered.
- ⑤ Press power button on the controller, beep tone send out, meanwhile enter the display interface .

## Step2. Massage

- ① Operate according to controller operation instruction.
- ② When massage stop, massage machine return to the default position, meanwhile "Shutting down" displayed on the controller, controller off after 15 seconds.

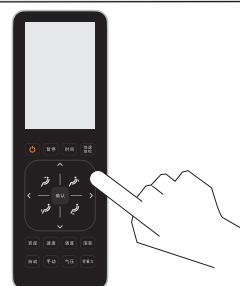

## Step3. Turn off the power

- ① When the chair is On, press On/Off button to turn off the massage chair and it will restore automatically.
- ② Turn off the power switch on the bottom of the back of chair after the rollers stay at storage position.
- ③ Unplug the power plug from the socket.



Warning

1. Before using, pull up the pillow, back cushion etc. to check if the PU material is broken, if there is damage, please stop using, unplug the chair, and ask for repairment.
2. Only plug to proper socket.



Attention

1. Before sitting down, make sure there is no things pinched between armrest, legrest , backrest and seat of the chair.
2. Make sure the chair is in returned position before using.
3. Do not stand on it when using the massage chair.

## Function Illustration

## ● Backrest down

Press this button on controller, the backrest will go down. Release this button, the backrest stops moving, the angle is locked in this position.



## ● Legrest extend and retract

Legrest can extend or retract within a range of 23 CM.



## ● Backrest up

Press this button on controller, the backrest will go up. Release this button, the backrest stops moving, the angle is locked in this position.



## ● Arm massage

Put arms between arm airbags before the embedded airbags filled with air. It will perform pinch massage techniques to arms and hands after airbags inflating.



## ● Legrest down

Press this button on controller, legrest will go down. Release this button, legrest stops moving, the angle is locked in this position.



## ● Shoulder massage

Multilayer extrusion airbags is deployed on both sides of the shoulder. Achieve pressure shoulder stretch massage, relieve shoulder fatigue.



## ● Legrest up

Press this button on controller, legrest will go up. Release this button, legrest stops moving, the angle is locked in this position.



## ● Foot roller massage

Footrest parts with roller massage and air pressure massage function. Through stimulating the foot reflex zones, and clear the body meridians, regulate and restore human organs function, improve the body resistance and immunity effectively.



## ● Zero gravity

Press the button "Zero" ,backrest go down and legrest raise up, the chair go into Zero gravity status automatically. Press the Button again, the backrest and legrest stop moving, and it will lock at this position. However to change the angles, we can keep comfortable massage status all the time.



1. Please make sure there is no people, no pets or any stuff within range for backrest to avoid unexpected hurt or property loss.
2. When adjusting the backrest, be careful the gap between the backrest and armrest.
3. When the legrest is moving, please do not stand on or leave from the seat, do not stop the legrest from moving in case of causing damage to the chair.
4. Please refer to control instruction for more details.

## Restoration of massage chair

- 1 Make sure there is no people or pet or anything within the range of backrest and legrest.



- 2 Make backrest and legrest restore to the normal position by controller. (or press ON/Off key to make backrest and legrest restore to the normal position)

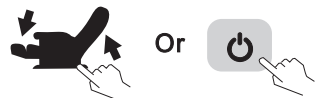

- 3 After restoring, put the controller into the pocket on inside of right armrest.



- 4 Put the pillow pad on to the right position.

- 5 Switch off the power.

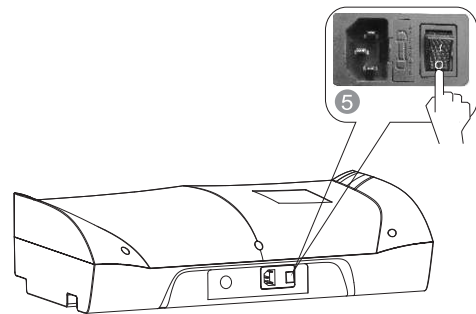

- 6 Unplug the electricity from the socket. (Attention: hold the right plug position)

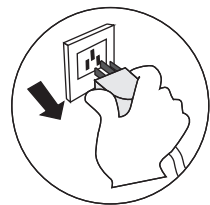

- 7 Clean the chair if necessary.



## Attention!

- After using, press ON/OFF to end all the massage method and wait for restoration.
- Make sure to cut the electricity to avoid any unexpected hurt to children or pets.
- After using, turn off the power, unplug the electricity. Avoid moisture, dirt and aging of insulation in case of causing damage.

## Synthetic leather

## ● General cleaning

Clean with tidy, soft and dry cloth slightly.



(Chemical or medical cleaning products are forbidden)



## ● If leather is dirty

- 1 Dip soft cloth into 3-5% neutral detergent solution, squeeze it then clean the stain on the surface gently.
- 2 Wash cloth, squeeze it and wipe with detergent.

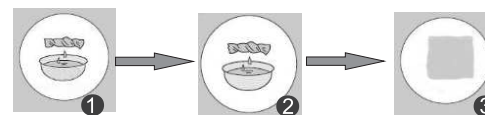

- 3 Clean it softly with dry cloth.
- 4 Allow to dry (air blower is prohibited)

## Cloth material

- 1 Dip cloth into weak neutral detergent, squeeze it and clean the material surface.

- (Diluent, gas, alcohol are prohibited)
- 2 Brush the dirty parts with weak neutral detergent. (avoid excessive brushing) Excessive cleaning may cause damage to cloth material.



- 3 Wipe with water-dipped but squeezed cloth.
- 4 Allow to dry.

## Plastic parts

- 1 Dip cloth into neutral detergent, squeeze it and clean.
- 2 Wipe with water-dipped but squeezed cloth.
- 3 Allow to dry.



## Clean the controller

- 1 Wipe with soft cloth after squeezing.
- 2 Allow to dry.

Propellant, diluent or alcohol are prohibited.



## About cleaning

- Before cleaning, unplug the electricity, don't touch plug with wet hands.
- Make sure hands are dry when plugging to the socket.
- If failed to follow the mentioned instruction, user may get electric shock or burned.

## FAQ and Troubleshooting

Trouble	Possible reason	Troubleshooting
The massage chair can't work after power is on.	Check if the control is on or not.	Open control switch
	Not choose massage function	Choose massage function
	Check whether the plug and socket in poor contact.	Make sure plug and socket are connected.
	Wire or plug has damaged.	Please ask manufacturer or appointed or authorized maintenance man for checking and replacement.
	The fuse burned out.	Replace fuse of same specification.
	Something wrong with inner circuit	Please ask appointed or authorized maintenance man for checking and repairing.
There is beep sound inside the massager while working.	It is sound of air pump, motor and mechanical parts.	Normal sound, no need to pay attention to it.
Different height of the left roller and right roller.	Massage rollers work on shifts.	Normal, no need to pay attention to it.
Sound suddenly becomes much louder while working.	Check if it is due to long time working.	Turn off the power to have the massager rest for over half an hour before next turn working.
	Inner parts fretted away due to long time work. It's normal	Please ask appointed or authorized maintenance man for checking and repairing.
Massage function suddenly stops while working.	Suddenly power-down	Connect the electricity power again
	Setting time is up.	Turn off the power to have the massager rest for over half an hour before next turn working.
Neither the backrest nor the legrest can be lay down.	Check if there are any obstacles; the chair overloads; for the sake of safety, sometimes the massage machine may automatically stop working.	Remove the obstacles; turn off the power to have the massager rest for over half an hour before next turn working.
The chair can't return to its original position.	Excessive operation; setting time is up.	Please ask manufacturer or appointed or authorized maintenance man for checking and replacement.
Electric wire or plug give out heat	It may work overload	Turn off the power to have the massager rest for over half an hour before next round working.
	Other abnormal case	Stop using, and ask appointed maintenance man for help.



Note: If the troubles are not caused by above reasons, please turn off the power switch and cut off the power, then contact the manufacturer or service agent to repair your chair.

## Technical data

Name	Massage Chair	Power	240W
Model	RK1901	NW/GW	Main body :74/89kg Legrest &footrest : 15.5/18kg
Input voltage	<input type="checkbox"/> AC120V, 60Hz <input type="checkbox"/> AC220V, 50/60Hz <input type="checkbox"/> AC240V, 50Hz	Packing size	Main body: 1580×850×860mm Legrest &footrest : 535×460×550mm (L×W×H)
Safety design	Class I		